

EX-H80

Explosion-proof Camera Housing

www.vipro.com.tw



Applicable for the factories having the explosive mixtures formed from class IIA, IIB and IIC T1-T6 group flammable gas, steam with air in area No.1 , No.2, and appearing the explosive hazardous area due to the mixture of flammable dust and air in area No.20, No.21 and No.22, such as oil field, chemical plant, port, oil storage, steamship, oil drilling platform, gas stations, coal mine, aviation, military, medicine, steel, firecrackers production, machinery, food processing and storage and so on.

Key features

- 304(316) stainless steel surface treated with fluorine-carbon spray, elegant structure, explosion-proof, dust-proof, water-proof, rust-proof
- Optics class toughened ultra-clear white explosion-proof glass, flux rate higher than 96%
- Invisible nano wiper, non-stick water, non-stick oil, dust-proof
- Optional temperature-controlled SCR semiconductor module to realize automatic heating and cooling functions, heater turned on when temperature lower than $-10^{\circ}\text{C} \pm 5^{\circ}\text{C}$
- Original stainless steel or Electro-polished surface (optional)
- Support over 80% camera on the market
- Camera cover customizable for larger size

Dimensions

(unit: mm)

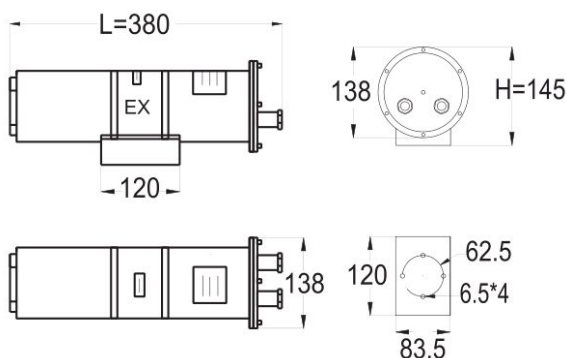

EX-H80R (with IR Lamp)



Technical Specifications

Product series		Explosion-proof Camera Housing
Model		EX-H80, EX-H80R (with IR lamp)
Mechanical features	Material quality	304 Stainless steel (316 optional)
	Surface treatment	Fluorine-carbon spray processing
	Anti-hazard classification	ExdIICT6/DIP A20 TA,T6
	Ingress Protection	IP68
	Interface spec	G-3/4"
	Weight	≤6.0kg (13.23lbs)
	Method of installation	Wall mounting
	Outer Dimension	380mm(L) x 138mm(W) x 145mm(H) / 14.96" x 5.43" x 5.71"
Electrical	Inner Max. Installation Dimension	300mm(L) x 65mm(W) x 65mm(H) / 11.81" x 2.56" x 2.56"
	Window Dimension	60mm(L) x 8mm(H) / 2.36" x 0.315"
	Input Voltage	AC220V/AC24V/DC12V, based on camera's power supply requirement
	Working Current	Based on camera's requirement
	IR Distance	30 meters
Environmental	Wavelength	850nm
	If monitoring in non-light conditions, please select infrared shield	
	Working temperature	-45°C~+70°C / -49°F~158°F
	Atmospheric Pressure	86~106kpa
	Relative Humidity	≤ 95%RH (±25°C)
Environmental	Certification	CNEX, ATEX, CE, FCC