

# HL820C

## 2.0MP HD 20x IR Network High Speed Dome

www.vipro.com.tw



- Integrated 16 bit processors, with low power consumption
- Built-in high-intensity OSRAM chips, achieving the long-range distance surveillance
- Precision 0.9° motor-driven, more stable and smooth low-speed control without jitter
- Using industrial-grade components, suitable for bad weather environment
- Suitable for Vehicle Surveillance installation

### Key Features

- 1080P Full HD Realtime resolution
- True Day/Night, WDR, 3D-DNR, Defog
- 20X Optical zoom; Dual stream and HD capture
- IR night vision distance at 80m
- Support variety of HD Platform connection
- IP66 Weather-proof design for car surveillance with special shock absorber CZ52
- With XD52 powerful magnet for portable outdoor vehicle monitoring
- Integrated with different kinds of HD camera module and HD sensor, achieving HD image capturing.
- Automatic 180° flip and panoramic monitoring without blind point, the location precision up to  $\pm 0.1^\circ$
- Running stably at low speed with super low noise
- Adopt the latest H.264 video compression algorithm and DSP processing chip and platform, high compression ratio, with high quality image, and built in with digital decoder
- Apply full digital control, flexible programming, drive line compact and simple design, could take rapid positioning and continuous tracking scan

### Accessories



CZ52 Shock Absorber



XD52 Magnet Base  
(optional)

### Dimensions (unit: mm)

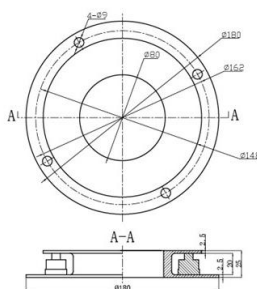
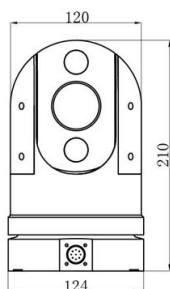

### Technical Specifications

HD Camera	Camera	20x, 2.0 Mega pixel camera module
	Model	HL820C
	Image Sensor	1/2.8" Progressive Scan CMOS
	Resolutions	50HZ:25fps(1920x1080) 60HZ:30fps(1920x1080) 50HZ:25fps(1280x720) 60HZ:30fps(1280x720)
	Min. Illumination	Color: 0.05Lux @ (F1.6, AGC ON) B&W: 0.01Lux @ (F1.6, AGC ON)
	S/N Ratio	>52dB
	Backlight Compensation	ON/OFF
	Iris, Focus	Auto/ Manual
	White Balance	Auto/ Manual/ ATW/ Indoor/ Outdoor
	Day & Night Mode	IR Cut Filter
	Electronic Shutter	1/1s ~ 1/30,000s
	Wide Dynamic Range	Support
Lens	Digital Noise Reduction	3D DNR
	Defog	Support
	IR Distance	80m (2 groups Infrared light) / 200 m (1 group infrared lamp with 1W linkage laser light)
	Focal Length	4.7-94mm
	Zoom	20X Optical zoom
	Aperture Range	F1.6-F4.4
	Angle of View	65.1-2.34degree (Wide-Tele)
	Min. Working Distance	10mm-1500mm (Wide-Tele)
	Video Compression	H.264/MJPEG
	Audio Compression	G.711u/G.711a/G.726
	Compression Output Rate	32 Kbps~16Mbps
	Ethernet	10Base-T / 100Base-TX, RJ45 connector
Network	Network Protocol	TCP/IP, HTTP, DHCP, DNS, DDNS, RTP, RTSP, PPPoE, SMTP, NTP, UpnP, SNMP, FTP, 802.1x, QoS, HTTPS, IPv6 (SIP, SRTP, optional)
	SD Card Interface	Micro SD Slot, 32GB capacity (Max.)
	Smart Alarm	Remote detection, Screen-covered alarm, Memory storage full, Memory storage wrong
	Video IE Browse	10 Users online simultaneous live view
	Stream	Dual streams
	User Rights	32 Users (Max.), 3 Levels: Administrator, Operator, Normal user* (browse only)
	Security Mode	User Authorization (ID/PW), MAC address binding; HTTPS encryption; IEEE 802.1x network access control, IP address filtering
	ROI Encoding	Support 24 areas, grade adjustable
	ONVIF	Support
	Pan / Tilt Range	Pan: 360° endless, Tilt: 0°~ 90° (Auto Flip)
	Pan / Tilt Preset Speed	Pan: 300°/s, Tilt: 120°/s
	Pan / Tilt Control Speed	Pan: 0.1°-220°/s, Tilt: 0.1°-90°/s
PTZ	Preset Positions	256
	Patrol	8 patrols, up to 32 presets per patrol
	RS-485 Protocols	Pelco-D, Pelco-P, Self-adaptive
	Alarm	1 input / 1 output
	Power Supply	DC12V/2.5A
	Ingress Protection	IP66 (Outdoor) TVS 4000V lightning, surge protection
	Working Temperature	-45°C~+60°C / -45°F~+140°F
	Humidity	90% or less
	Dimensions	Φ124x210mm / Φ4.88"x8.06"
	Weight	2.5KG / 5.51LBS
General		